



dan pearlman

EXPERIENCE ARCHITECTURE

EXPERIENCING CONSERVATION

BY KIERAN STANLEY

ZOO DESIGN CONFERENCE 2019 | WROCLAW, POLAND

PERCEPTION | CONTRA



PERCEPTION | CONTRA









4 MAIN TASKS | EDUCATION



4 MAIN TASKS | RESEARCH & SCIENCE



4 MAIN TASKS | LEISURE ACTIVITIES



4 MAIN TASKS | CONSERVATION



CONSERVATION | EX-SITU & IN-SITU

Allwetterzoo Muenster



**ALLWETTERZOO – WELTWEIT AKTIV IM ARTENSCHUTZ
MÜNSTER**

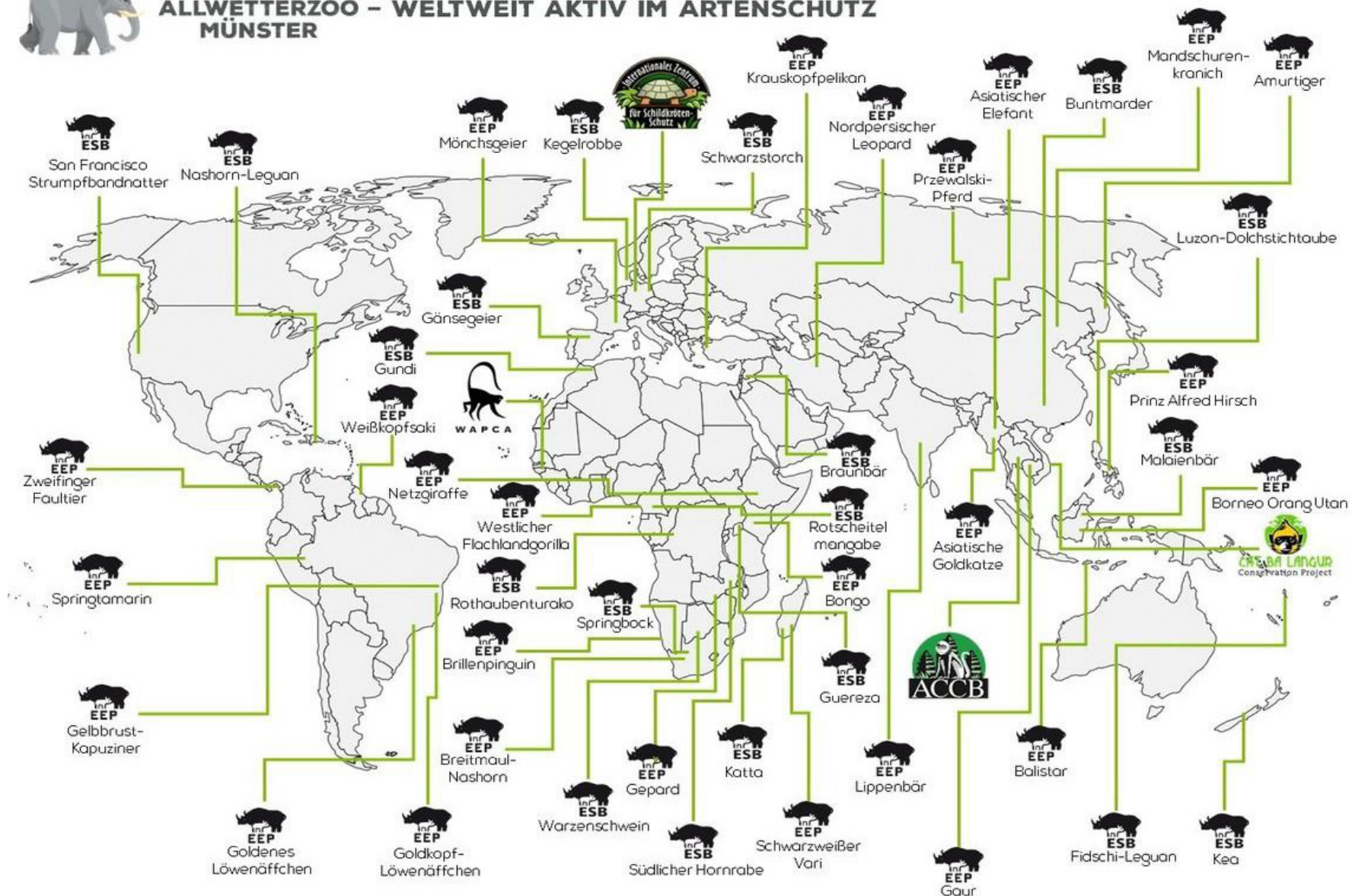

CONSERVATION | EX-SITU & IN-SITU

San Diego Zoo Global



CONSERVATION | EX-SITU & IN-SITU

Wildlife Conservation Society



CONSERVATION | EX-SITU & IN-SITU

in cooperation with Tierpark Berlin





**AS PART OF OUR HOLISTIC APPROACH,
CONSERVATION SHOULD BE IMPLEMENTED IN THE
STRATEGIC DEVELOPMENT AND SHOULD BE
CONSIDERED IN DESIGN & COMMUNICATION**

DESIGNING CONSERVATION | LANDSCAPE

Chester Zoo | Islands



DESIGNING CONSERVATION | LANDSCAPE

local flora & fauna



DESIGNING CONSERVATION | ARCHITECTURE



Munich Tierpark Hellabrunn | fish breeding station



DESIGNING CONSERVATION

ARCHITECTURE



Chester Zoo | Sumba School House



DESIGNING CONSERVATION | ARCHITECTURE

Zoo Wuppertal | Fuhlrott Zentrum

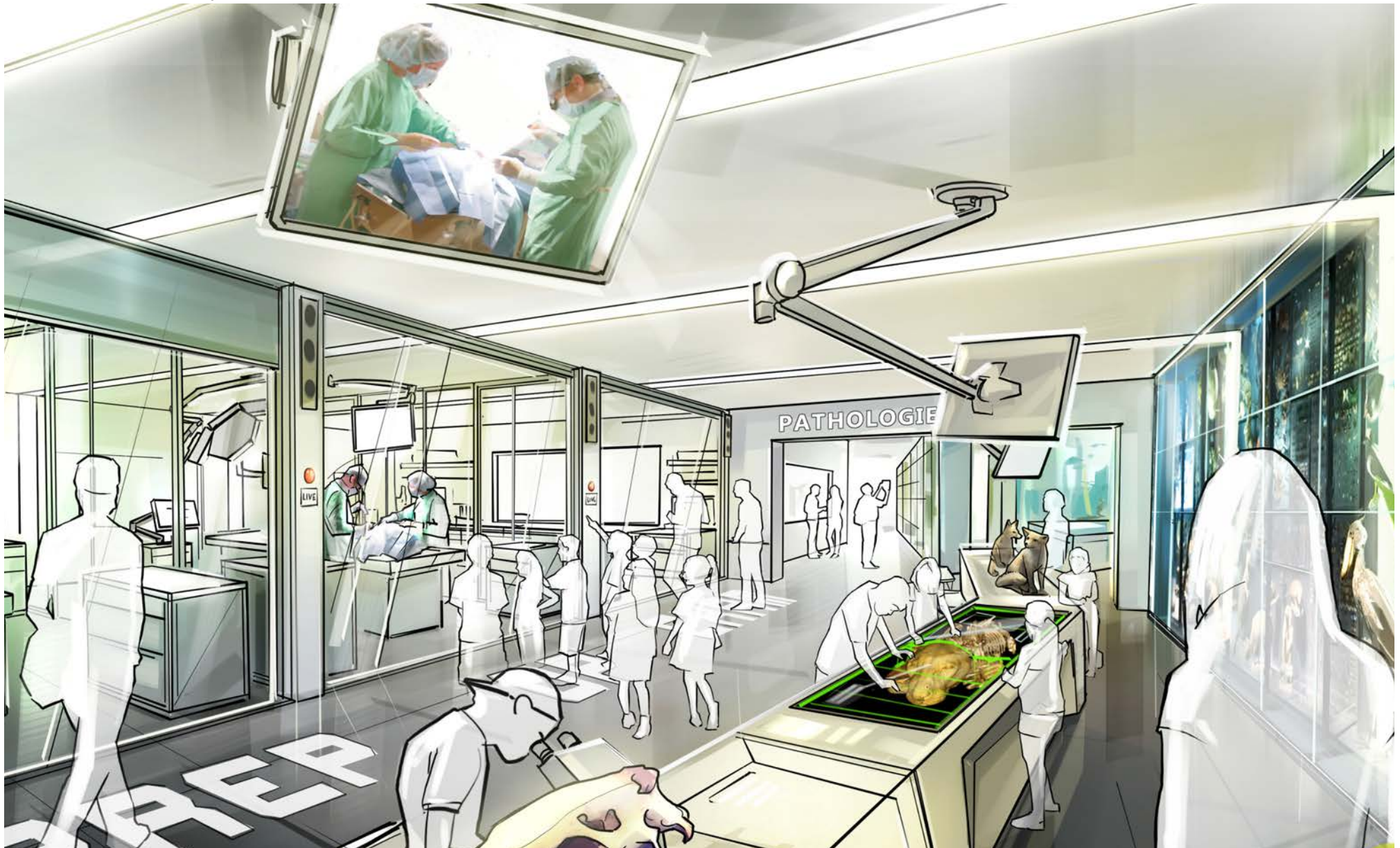

DESIGNING CONSERVATION | ARCHITECTURE

Zoo Berlin | Rhino & Tapir exhibit



COMMUNICATE CONSERVATION | EXTERN

Monterey Bay Aquarium | Seafood Watch



COMMUNICATE CONSERVATION | EXTERN

Chester Zoo | Palm Oil Campaign



COMMUNICATE CONSERVATION | RETAIL

Zoo Zurich | sustainable products

Loro Parque | recyclable water bottles



COMMUNICATE CONSERVATION | GASTRONOMY

Zoo Hannover | Farmers Market & local products



COMMUNICATE CONSERVATION | WITH VISITORS



Australia Zoo





Islands

What's the **treasure**?

What makes it **unique**?

What makes it **fragile**?

Ecosystem

Landscapes

Animals

Culture

What is **Chester Zoo** doing to protect the treasure?

What can **you** do to protect the treasure?

Act for Wildlife!

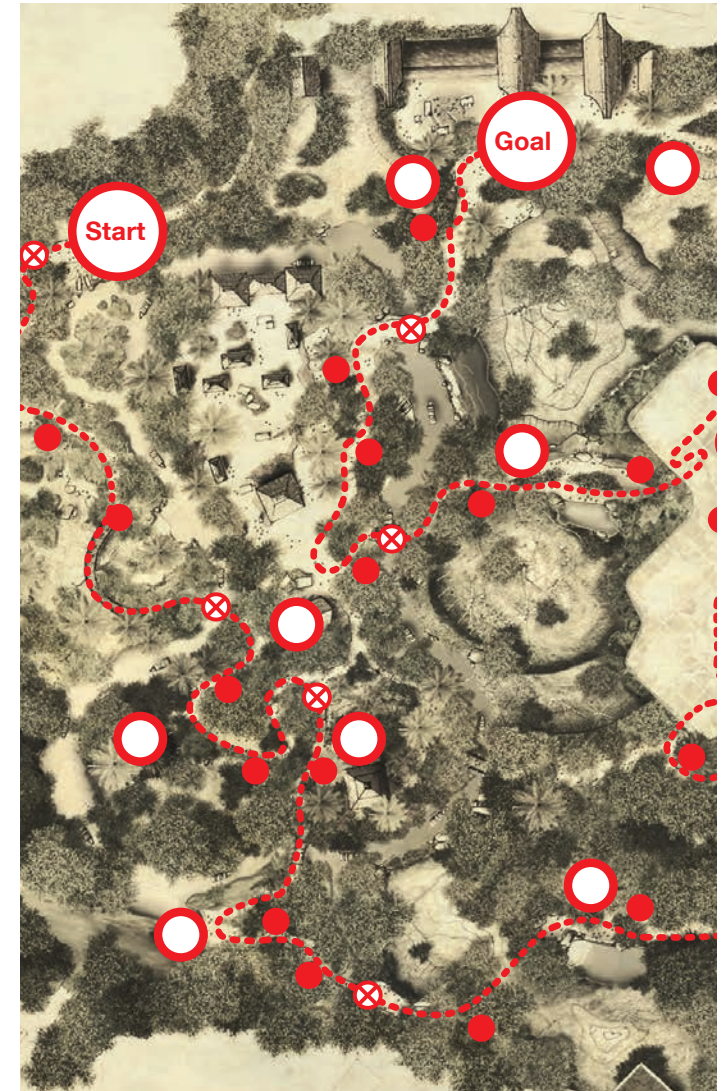

EXPERIENCE CONSERVATION | AUTHENTIC SETTINGS



EXPERIENCE CONSERVATION | INTUITIVE STORIES



EXPERIENCE CONSERVATION | DIRECT ENCOUNTERS



EXPERIENCE CONSERVATION | PERSONAL MESSAGES





Cold science characteristics

- Handwritten information in blue
- scientific facts
- detailed scientific colored illustration

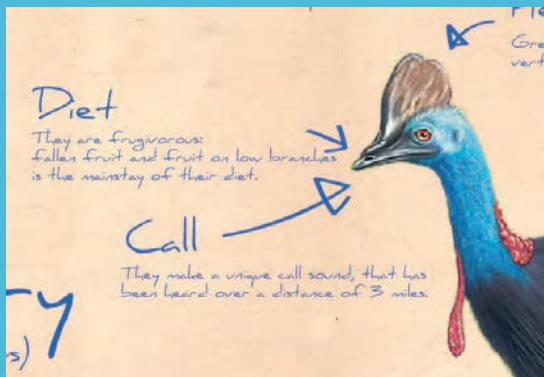

Hot stories characteristics

- Handwritten notes in red
- fun facts
- rough pencil sketches



EXPERIENCE CONSERVATION | PARTICIPATION



Want to hear the amazing call of the Cassowary. Push the button!

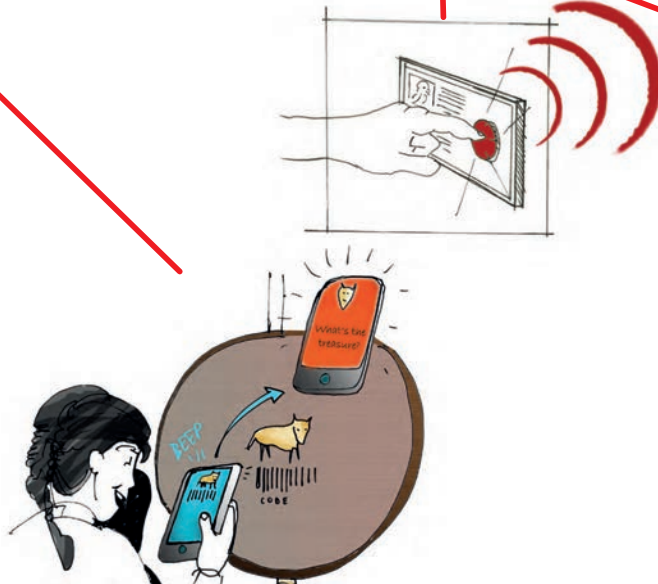



What is
Chester Zoo
doing to help?



Chester Zoo Team building bridges for Orang Utans

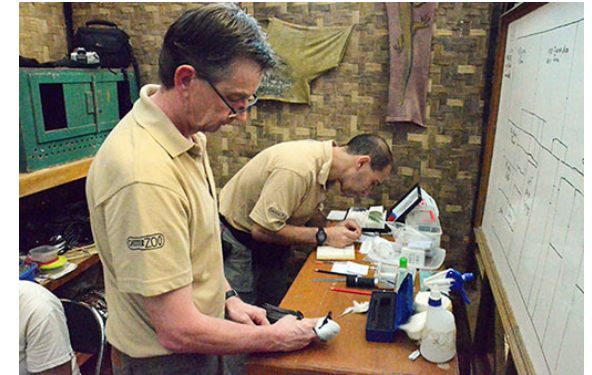

What **you** can do
to help?





Warty pig photopoint: Save the last mohican!





Foreign term collected on the treasure quest
e.g. Indonesian

Cinta alam

?

Translation at Point of Achievement

Love of nature

!

Act for Wildlife!





**DELIVER POSITIVE MESSAGES
TO EMPOWER PEOPLE WITH KNOWLEDGE!**





Thank you!

CONTACT



KIERAN STANLEY

CEO | Creative Director
k.stanley@danpearlman.com

JÖRG SCHNEIDER

Project Management
j.schneider@danpearlman.com

JOKE LEON KLEIN

Architecture
j.klein@danpearlman.com

dan pearlman Erlebnisarchitektur

Gesellschaft von Architekten und
Innenarchitekten mbH

Kieffholzstrasse 2
12435 Berlin
Germany

Phone +49 30 - 53 00 05 60

Fax +49 30 - 53 00 05 78

office-ea@danpearlman.com
www.danpearlman.com

COPYRIGHT

All ideas and proposals documented in this presentation are the intellectual property of dan pearlman. The unauthorised usage, complete or partial duplication or transfer of any part of this presentation is prohibited. dan pearlman concepts are subject to the applicable copyright laws of Germany. Copyrights are not automatically included. All rights of images used within this documentation must be clarified separately, prior to partial or complete publication (e.g. planning documents, reports, booklets).